



SUPPORT WELLBEING WITH BIOUP

The Signify logo, featuring a green circle with a white 'S' inside, followed by the word 'ignify' in a lowercase, teal-colored sans-serif font.

The LUMIPARTS logo, consisting of a stylized 'LP' symbol in white and orange, followed by the word 'LUMIPARTS' in a bold, uppercase, sans-serif font. Below it is the tagline 'Mastering the needs of lighting' in a smaller, lowercase font.



PERSONAL APPROACH

"We passionately enlighten our business partners by providing flexible and personalized lighting solutions while expanding nationally and internationally through healthy and sustainable relationships."

At Lumiparts, we believe in a global passion for people, entrepreneurship, and adventure. We inspire ourselves and others to continually evolve because driven passion never stands still. Lumiparts illuminates the passion of entrepreneurs and end-users in a unique way by providing complete lighting solutions. With a personalized approach, we create tailor-made products and keep them in stock. Together, we master the needs of lighting!

We specialize in delivering and creating flexible lighting solutions that can be tailored to every specific customer and project requirement. We maintain close contact with our customers and, in addition to our standard lighting products, offer customized and tailor-made White Label and OEM fixtures. We understand that each project is unique, and personalization is the key to every lighting project! At the service level, we provide our own assembly department where all preferences are welcome, various market-focused leaflets, demo boxes, and, of course, a listening ear. This way, we offer the best advice and let our products, partners, and end customers shine together.

ASSEMBLY, OEM & WHITE LABEL

All fixtures and special requests find their way to our assembly department. Here, our skilled team meticulously prepares all products for use, seamlessly merging various components into a unified whole. We customize each product, ensuring precision in cutting LED profiles down to the millimeter using our specialized saw table.

Furthermore, we provide the opportunity to rebrand our products, allowing you to establish your own brand identity. Our passionate team, during the assembly process, ensures that your selected products bear your unique brand label. This is made possible through the White Label & OEM concept. Choose your fixtures, share your company details, logo, and preferred product numbers with us, and we will take care of the rest for you!

"To illuminate our world by inspiring our employees, customers and suppliers with our passion for lighting.

Together, we'll be the masters of lighting."

FLEXIBLE SOLUTIONS

We go that extra mile to exceed your expectations and remain flexible. Our business office, through its procurement policies, ensures a wide range of components is always available, allowing many of our fixtures to be assembled and delivered directly from stock. Additionally, we source our components with attention to detail, making them interchangeable in most cases. This way, we always find a suitable solution for your project. Need a different reflector, ring, or driver? No problem! Our large warehouse, like the office, is located in Nieuwkoop, ensuring proximity and making us unique in providing flexible lighting solutions.

RELIABLE LIGHTLAB

Because we've been active since 1985, we have accumulated extensive knowledge within the market. We operate based on expertise and craftsmanship at both the product and service levels. We align our efforts with the needs of each segment and have our own light lab where we meticulously measure our fixtures. This allows us to provide accurate information and generate clear EPREL reports. These EPREL reports are made available to every partner, and it's also possible to receive the LDT files of our fixtures. We are enthusiastic about embarking on new ventures and are always open to sharing knowledge on a global scale.



Light extends its influence beyond the realm of the **visual**.

As the indoor lifestyle becomes increasingly prevalent, we now spend over 90% of our time indoors, with a significant 36% dedicated to workplace environments. However, the more time we spend indoors, the less we benefit from the positive influences of natural daylight.

Light plays a crucial role not only in facilitating clear vision but also in influencing our biological functions and promoting emotional well-being. The harmonious integration of these factors is vital for overall wellness and serves as the foundation for circadian lighting.

Despite the significant contribution of light's biological impacts to our general well-being, indoor lighting levels often prioritize the visual aspects of light. In today's context, it is crucial to recognize the non-visual dimension of light to effectively enhance its biological impact. BioUp, a spectrally tunable technology by Signify, is designed with a focus on the non-visual aspects of light. It emulates daylight and is specifically engineered to provide melanopic advantages to individuals indoors, particularly those with limited exposure to natural light.

Lumiparts is Partner of 

CASAMBI



Benefits of melanopic light

Melanopic light is crucial for syncing our internal body clock with the effects of light beyond what we see. When you design your building with melanopic lighting in mind, it brings the benefits of natural daylight inside, making spaces more comfortable, promoting well-being, and enhancing performance. This special kind of light is closely connected to:



Daytime engagement



sleep-wake rhythm (circadian rhythm)



The light spectrum

What is melanopic-EDI?

The melanopic equivalent of daylight illuminance (melanopic-EDI), which is measured in lux, serves as the circadian metric endorsed by the International Commission on Illumination (CIE). It evaluates the stimulation of non-visual photoreceptors (ipRGCs) in our eyes, revealing how our bodies will respond. This response is affected by both the light's spectrum and intensity.

What is MDER?

The melanopic daylight efficacy ratio is a spectral measure that assesses the biological impact of artificial light sources in comparison to daylight (6500K). Melanopic lighting can affect various aspects such as energy levels, sleep quality, mood, and other factors. A reference daylight spectrum has a melanopic-EDR of 1. Usually, artificial lighting has a lesser biological effect than daylight, with the MDER being below 1.

Non-visual aspects of light

Spectral sensitivity

Visual system ●
Non-visual system ●

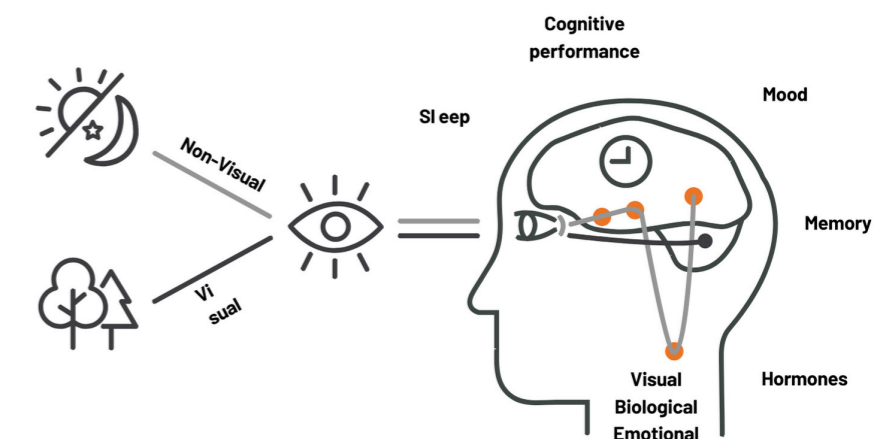
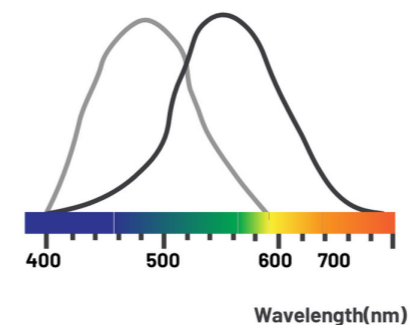

Source: Signify, Schlangen, L.J.M., & van der Zande, B. M. (2022). The power of healthy daytime lighting in indoor settings: melanopic lighting advances and office applications (Version 1). Zenodo. <https://doi.org/10.5281/zenodo.7362816>

In the early 21st century, researchers found that there are special cells in our eyes, called ipRGCs, containing a pigment called melanopsin. These cells are very sensitive to the blue part of light. When light stimulates melanopsin, these cells send a signal (not related to seeing) to our body's internal clock. This helps keep our bodies in sync with the 24-hour day-night cycle, supporting alertness during the day and better sleep at night.

1. Impact of Windows and Daylight Exposure on Overall Health and Sleep Quality of Office Workers: A Case-Control Pilot Study, 2014.
2. <https://www.assets.signify.com/is/content/Signify/Assets/philips-lighting/global/20210520-brochure-melanopic-light.pdf>
3. <https://www.assets.signify.com/is/content/Signify/Assets/philips-lighting/global/20220826-the-power-of-healthy-daytime-lighting-white-paper.pdf>

What is Bioup from Signify

BioUp technology is capable of tuning specific wavelengths in the LED light spectrum, allowing for precise adjustments. By incorporating cyan light into the LED spectrum, BioUp promotes biological well-being. While you might not notice changes in the visual color or light intensity, you will feel and perform better.

BioUp replicates aspects of natural daylight that are not visually apparent but have a significant effect. It attains a high Melanopic Daylight Efficacy Ratio (MDER) at cooler CCT levels without compromising efficacy, resulting in a spectral composition similar to natural daylight.

What differentiates BioUp:

- Higher Melanopic-DER levels up to 0.97 mean more melanopic light per lumen.
- Increasing Melanopic-DER * LER results in more melanopic light per watt of radiation, leading to higher efficiency (up to 19% more).
- Having the flexibility to adjust CCT with MDER values across a broader spectrum, ranging from 5000K at 0.97 to 2700K at 0.44, enables better daylight simulation.

The graph below shows the cyan peak at 480 nm delivering optimal melanopic benefits. The table below shows the CRI and MDER values throughout the broad CCT range.

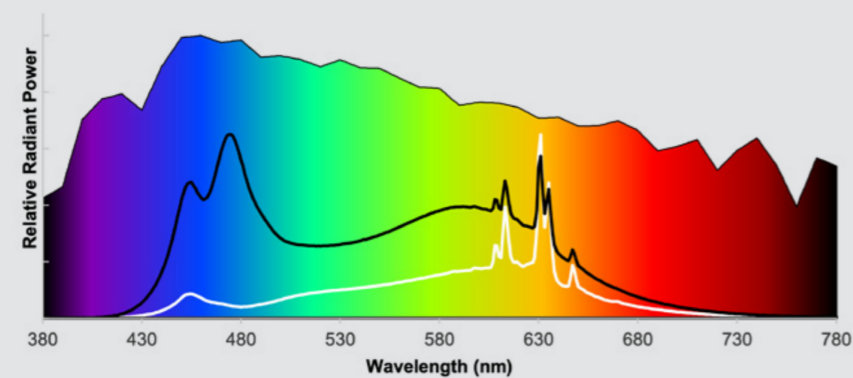

	2700K	3000K	3500K	4000K	5000K
CRI 1	94	91	88	86	82
MDER 2	0.44	0.59	0.72	0.82	0.97

Representative data based on product.

1. Color Rendering Index (CRI) is calculated in accordance with CIE 013.3-1995.
 2. Melanopic Daylight Efficacy Ratio (MDER) is the measure for "spectral melanopic efficiency" as defined in CIE S 026-2018. 3. Standard daylight (D65) has an MDER value of 1.



Suave V2

LED panel

UGR <19 @ max. 1050mA
 Size 595*595mm
 System Power 33W, 38W, 45W
 CRI >80Ra
 CCT 3000K 4000K
 System Lumen 3505lm-5004lm
 System Efficacy 106lm/W-117lm/W
 LOR Up to 80%
 Cover PMMA Opal Diffuser
 L+B values (50.000 hr) L80B10 (50.000h)

SMART WITH HIGH COMFORT THROUGH LOW GLARE



Suave V2 Inlay panel

Discover the Suave, our premium recessed panel that seamlessly caters to the demand for a sustainable, functional, and human-centric design. The Suave ensures excellent visual comfort with a low Unified Glare Rating (UGR) of less than 19. Additionally, the Suave V2 is compatible with the human-centric lighting modules Tunable White and Bioup, creating a lighting environment tailored to natural daylight. This enhances the well-being and comfort of those exposed to the light of the Suave. Moreover, the Suave can be extended with smart controls such as Dali or Casambi, allowing you to easily create a smart and sustainable design for offices and public spaces.

Suave panel



Lighting and the WELL Building standard™



In the WELL Building Standard, the concept 'Light' covers nine features, one of which is Circadian Lighting Design (L03). This provides guidelines on ways to minimize disruption to the circadian system, enhance productivity, support relaxation and provide appropriate visual acuity. Previously, industry standards accounted only for horizontal lux, which measures task lighting that shines on a flat surface such as a desktop. The new approach considers vertical lux, light that shines vertically and enters the pupil at eye level directly impacting our melanopic response To receive points towards the WELL v2 standard, you must achieve 250 lux M-EDI (D65) at eye level for a period of at least 4 hours a day.

¹ World Green Building Council. Health, Wellbeing & Productivity in Offices: The next chapter for green building. 2014
² Miller NG, Pogue D, Gough QD, Davis SM (2009) Green buildings and productivity JOSRE 1(1):65-89
³ Guy R, Newsham, Jennifer A, Veitch & Yitian (Vera) Hu (2018) Effect of green building certification on organizational productivity metrics, Building Research & Information.

BioUp-Enabled Lighting with Connected Technology

Light has a visual impact, a biological impact and emotional benefits. The combination of these elements is essential for people's well being and the foundation for human-centric lighting.



Build well
 Increase your building's appeal and achieve WELL Building Certification.



Feel well
 Lead the way to healthy, more engaging workspaces with personalized lighting control.



See well
 Improve comfort and light levels with LED lighting.



Perform well
 Help everyone thrive at work with the right light at the right time during the day.

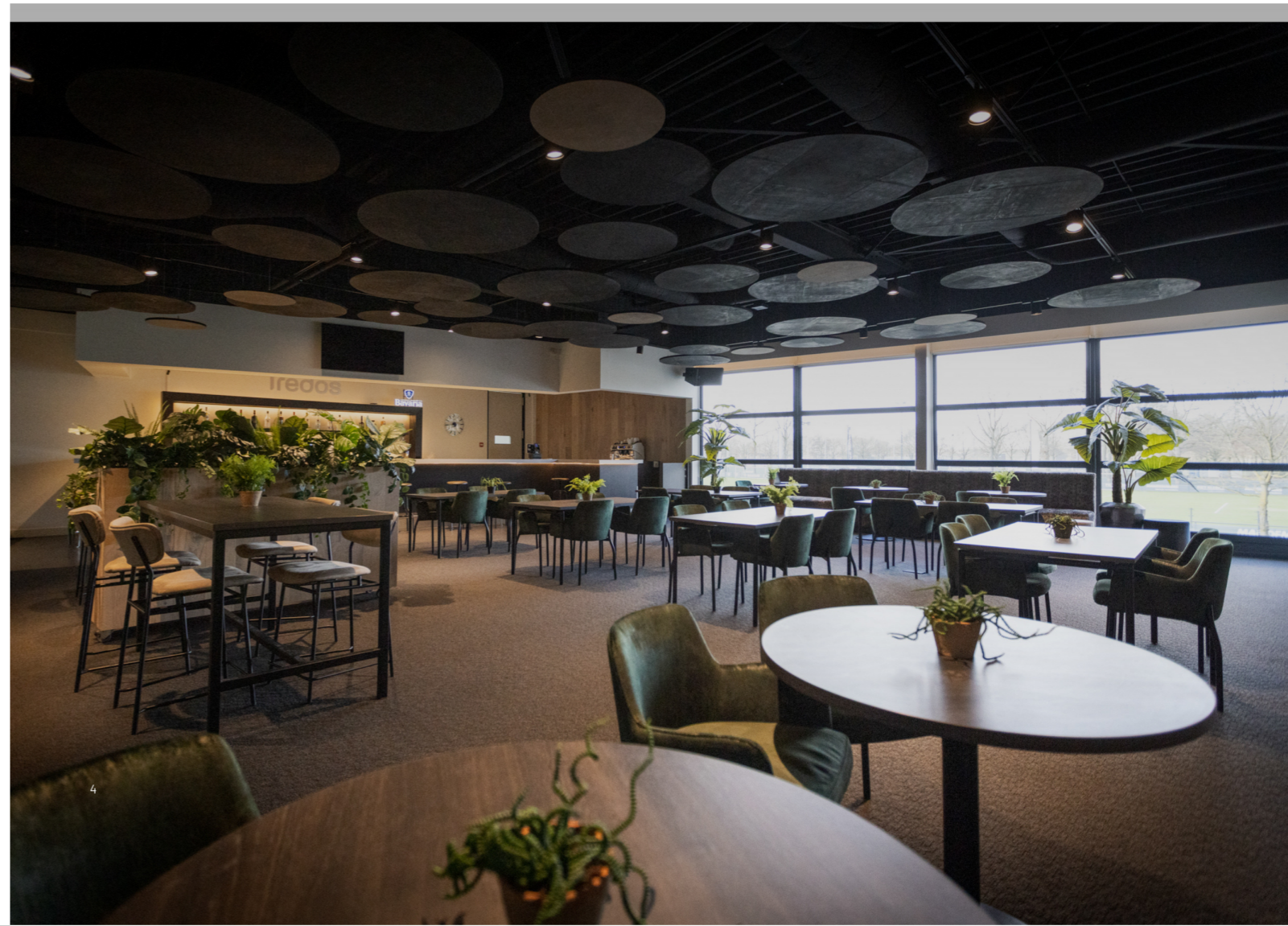



MODERN & EFFICIENT



XLH | XLH up-down

Surface, pendant & track

The XLH and XLH up-down fixtures redefine modern lighting, providing customizable options for a personal touch. Whether in the form of pendants or tracks (available in 0.9m, 1.2m, and 1.5m sizes), these fixtures not only deliver quality illumination but also prioritize human-centric lighting with Bioup and Tunable White options. Effortlessly controlled through Casambi, they bring ease and sophistication to any space. Choose between opal or micro-prismatic finishes to suit your style and enhance your surroundings with a superior lighting experience and improved well-being.

XLH up & XLH up/down



More lighting flexibility with Tunable White

Tunable white solutions offer the freedom to create different ambiances in offices, schools, retail spaces, and healthcare environments.

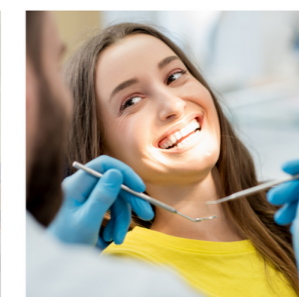
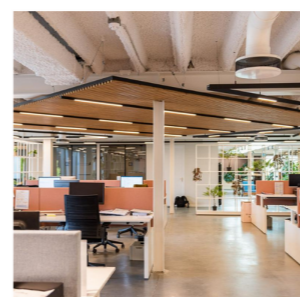

Dynamics

Automatically mimic daylight patterns by adjusting color temperature and brightness levels with respect to the time of day.

Scene set

A combination of predetermined presets instantly sets the scene for room ambiance that supports the next scheduled task or spontaneous activity.

Personal control

Get more flexibility and easily change LED intensities and correlated color temperature (CCT) from warm white (2700K) all the way to cool white (6500K).



XLH or XLH up/down

Single light profile or Double light direct and indirect
 Length: 0.9m | 1.2m | 1.5m
 Fixture colour: White | Black | Aluminum
 CCT: 3000K | 3500K | 4000K Bio-Up TW | Bio-Up 4200K
 Driver: 35W or 60W on/off | 35W or 60W DALI | 36W or 75W DALI
 flexitone | 35W or 60W Casambi
 Cover: micro-prismatic UGR <19 | opal UGR<22
 Cable: 1 meter | 2 meter
 Cable colour: White | Black | Transparent | Transparent DALI
 End-Cap: White | Black | Aluminum



Light up interior environments with BioUp

- Dynamic, 480 nm, cyan-enhanced LED spectrum can provide optimal melanopic benefits at typical indoor CCT levels
- Supports daytime circadian rhythm for engagement during the day and good sleep quality at night
- CCT range (2700K - 5000K)
- CRI of 82-94 throughout the range
- R9 value of 62-76 throughout the range
- Wired and wireless control options: Interact, 0-10V, DALI, other third-party controls
- Can contribute towards WELL v2 Circadian Lighting Design points by achieving 250 lux M-EDI (D65) at eye level for a period of at least 4 hours per day
- Available on our Ocla, Baza, XLH, Suave and more!

Significant melanopic lighting benefits
Luminaires



Baza 

Downlighter 

UGR: <19
IP: 44
Extension ring available
Colour: White | Black
Size: 110mm | 140mm | 165mm | 190mm | 230mm
Wattage: 8,5W - 31,6W
CRI: >80Ra
CCT: 3000K | 4000K
System Lumen: 3505lm-5004lm
System Efficacy: 103lm/W-125lm/W
Reflector: Matt | Glossy
L+B values (50.000 hr) L80B10 (50.000h)

HIGH-QUALITY, EXTENSIVE AND EFFICIENT



Baza Downlighter

Efficient, durable and at the same time available in sizes from 110 mm to 230 mm with an optional smart cover ring for effortless integration into existing sawing sizes to save time and costs. Discover brightness and comfort, adjust color temperatures and control the light with advanced options such as DALI or Smart Lighting or improve the lighting experience with a human centric lighting module. More safety? The Baza is also available with emergency lighting option.



Baza downlighter



Mastering the needs of **BioUp** Lighting.

LET'S STAY IN TOUCH **& EXPERIENCE YOURSELF**



We recognize that choosing the right lighting solution can be challenging. Do you have any questions about this brochure, the technology, or our products? Feel free to get in touch! If you prefer to experience our lighting firsthand, we offer the opportunity to request a complimentary demo. During the demo, we'll showcase how our smart, sustainable, and functional lighting can transform your space.

Don't hesitate to contact us by scanning the QR code.



Nijverheidsweg 2 | 2421 LR Nieuwkoop | Netherlands

T +31(0)172 574 500 | info@lumiparts.nl | www.lumiparts.nl

Follow us for more!

@LUMIPARTSLIGHTING

